

Welcome to Concord Lifting Equipment Ltd. We are one company with four locations.

All our engineers are extensively trained in courses with our manufacturers to provide the very best service for our customers who come back to us time and time again. Remember we don't just hire, we also sell, repair, maintain and test all material handling and height equipment anywhere in the world and have been doing so successfully for years.



| Contents | | |
|----------------------------|---|----|
| Lifting | Electric Chain Hoists | 2 |
| | Gantry Hoist & Wire Rope Hoist | 3 |
| | Minifor Winch & Tirak Winch | 4 |
| | Gin Wheel & Rope | 4 |
| | Manual Chain Block | 5 |
| | Ratchet Lever Hoist | 5 |
| | Manual Tirfor Winch | 6 |
| | Adjustable mobile gantries | 6 |
| | Spreader Beams / Niko Track | 7 |
| | Genie Machines | 8 |
| | Plasterboard Lifter | 9 |
| | Floor Crane | 9 |
| | Adjustable Height Hoist Support | 9 |
| Jacks | 10 | |
| Manhole Lifter | 11 | |
| Lifting Accessories | Girder Trolley & Plate Clamp | 12 |
| | Adjustable Girder Clamp | 12 |
| | Transformer and leads | 13 |
| | Flat Belt Sling/Round Sling | 13 |
| | Chain Slings- 1 leg, 2 leg, 4 leg | 14 |
| | Barrow Sling & Skip Lifting assembly | 15 |
| | Dee & Bow Shackles | 15 |
| | Manhole ring lifting pin | 16 |
| | Buckets/Muck Skips | 16 |
| | Frimda/Deha clutches | 16 |
| Moving | Brick Lift/Crane Forks | 17 |
| | Block Grabs & Bottle Carrier | 17 |
| | Kerb Handling / Vacuum Block Grab | 18 |
| | Fork Truck Tine bracket / Jib Booms | 18 |
| | Man Riding cages/Stretcher cage | 19 |
| | Pipe or Beam bogie | 19 |
| | Pallet Truck/Rough Terrain pallet truck | 20 |
| | Flat Top/Turnable Truck/Sack Truck | 21 |
| | Stair Climber / Plaster Board Trolley | 21 |
| | Piano Skate / Skoots | 22 |
| | Furniture Moving Trolley/Skate | 22 |
| | Roller Crowbar / Machine Skates | 23 |
| Safety | Safety harness & Inertia Reel | 24 |
| | Temporary lifeline / Roof Man Anchor | 24 |
| | Man Riding Tripod / Bosun's chair | 25 |
| Vacuum Handling | Vacuum handlers | 26 |
| | Stillage Trolley | 26 |
| Test Weights | Test Weights | 27 |
| | Load Cells / Load Indicators | 27 |
| Concord Information | Terms & Conditions | 28 |
| | Where to find us, Guidelines | 31 |



- Take the hard work out of lifting and lowering loads through vertical distances.
- Runs off 110v, 1ph supply
- Lift heights from 6M to 36M
- 250kgs to 3T

110-Volt Electric Chain Hoist Technical Specification

| H.O.L (M) | 250kgs | 500kgs | 1T | 2T | 3T |
|-------------|--------|--------|--------|--------|-----------|
| 6 M | 8m/min | 4m/min | 4m/min | 2m/min | 1.35m/min |
| 9 M | 8m/min | 4m/min | 4m/min | 2m/min | 1.35m/min |
| 12 M | 8m/min | 4m/min | 4m/min | 2m/min | 1.35m/min |
| 15 M | 8m/min | 4m/min | 4m/min | 2m/min | N/A |
| 18 M | 8m/min | 4m/min | 4m/min | 2m/min | N/A |
| 24 M | 8m/min | 4m/min | 4m/min | N/A | N/A |
| 30 M | 8m/min | 4m/min | 4m/min | N/A | N/A |
| 36 M | 8m/min | 4m/min | 4m/min | N/A | N/A |



- Take the hard work out of lifting and lowering loads through vertical distances
- Runs off 400/440v, 3ph supply
- Lift heights from 6M to 30M
- Dual speed an option on power travel trolley
- 500kgs to 5T
- Travel trolley has power speed of 12M/min

440-Volt 3ph Electric Chain Hoist Technical Specification

| H.O.L (M) | 500kgs | 1T | 2T | 3T | 5T |
|-------------|--------|--------|--------|----------|----------|
| 6 M | 9M/min | 8M/min | 4M/min | 2.9M/min | 2.9M/min |
| 9 M | 9M/min | 8M/min | 4M/min | 2.9M/min | 2.9M/min |
| 12 M | 9M/min | 8M/min | 4M/min | 2.9M/min | 2.9M/min |
| 15 M | 9M/min | 8M/min | 4M/min | 2.9M/min | 2.9M/min |
| 18 M | 9M/min | 8M/min | 4M/min | 2.9M/min | 2.9M/min |
| 24 M | 9M/min | 8M/min | 4M/min | 2.9M/min | N/A |
| 30 M | 9M/min | 8M/min | 4M/min | 2.9M/min | N/A |

Extra-Power travel trolley
£ POA





- Easy to assemble
- Simple to operate
- Available in variety of sizes
- 110v, 1ph
- The Scaffold hoist can be swung in by one hand
- The Gantry hoist can be pulled in by one hand
- Both will accept a variety of slings or buckets to facilitate lifting loads

300kgs Gantry Hoist

150/200kgs Scaffold Hoist

Technical Specification

| H.O.L (M) | S.W.L | Type |
|-----------|---------|----------------------------|
| 30 M | 300 kgs | Beam Mounted Gantry Hoist |
| 30 M | 300 kgs | Frame mounted Gantry Hoist |
| 25 M | 150 kgs | Scaffold Hoist |
| 30 M | 200 kgs | Scaffold Hoist |

On the frame mounted versions not tied back to a scaffold but standing independently on the roof, 14 No x 25kgs hand weights will be required at an additional rate of £1.50 per weight per week.

230kgs Wire Rope Hoist Technical Specification

- CWS 230
- Rapid lift wire rope hoist
- 14M/min

230 kgs x 24 M



- The Minifor and Tirak from Tractel are portable lightweight hoists
- Enables an unlimited height of lift

300/500kgs 110v Minifor Winch 1T 440v Tirak Winch Technical Specification

| Model | S.W.L |
|-------|------------------|
| TR 30 | 300 kgs |
| TR 50 | 500 kgs |
| Tirak | 1T |
| TR 50 | Radio Controlled |
| TR 30 | Radio Controlled |

Minifor/Tirak wire ropes to suit TR30, TR50 & Tirak

| Model | Length (Metres) |
|-------|-----------------|
| TR 30 | 20 M |
| TR 30 | 30 M |
| TR 30 | 40 M |
| TR 30 | 50 M |
| TR 30 | 60 M |
| TR 30 | 80 M |
| TR 50 | 30 M |
| TR 50 | 40 M |
| TR 50 | 50 M |
| TR 50 | 60 M |
| Tirak | 30 M |
| Tirak | 40 M |
| Tirak | 50 M |



- Manual pulley used with varying length ropes

Gin Wheel and Ropes Technical Specification

250kgs Gin Wheel

10M Rope

20M Rope

30M Rope

40M Rope



- Lightweight construction with heavy-duty capability
- All are available with slack chain bags for rigging applications
- Versatile and reliable

| Manual Chain Block Technical Specification | | | | | |
|---|-------|-------|-------|-------|-------|
| H.O.L (M) | S.W.L | S.W.L | S.W.L | S.W.L | S.W.L |
| 3 M | 500kg | 1T | 2T | 3T | 5T |
| 6 M | 500kg | 1T | 2T | 3T | 5T |
| 9 M | 500kg | 1T | 2T | 3T | 5T |
| 12 M | 500kg | 1T | 2T | 3T | 5T |
| 15 M | 500kg | 1T | 2T | N/A | N/A |
| 18 M | 500kg | 1T | 2T | N/A | N/A |
| 24 M | 500kg | 1T | 2T | N/A | N/A |
| 30 M | 500kg | 1T | N/A | N/A | N/A |
| Chain Bag | | | | | |



- For work in confined spaces
- Ideal for pulling or positioning loads
- Available in 750kg to 6T capacities with a standard 1.5M height of lift (longer if required)

| Ratchet/Lever Hoist Technical Specification | | | | |
|--|--------|-------|-------|-------|
| H.O.L (M) | S.W.L | S.W.L | S.W.L | S.W.L |
| 1.5 M | 750kgs | 1.5T | 3T | 6T |
| 3 M | 750kgs | 1.5T | 3T | 6T |
| 6 M | 750kgs | 1.5T | 3T | 6T |





- A compact winch for high lifts and long hauls
- Incorporating all the quality associated with the Tractel brand
- Tirfors are available in up to 3.2T lifting capacity
- Heavier loads can be handled when used in combination with Snatch Blocks
- All winches supplied with operating handle
- 60M & 100M ropes supplied on cable reel

Manual Tirfor Winch Electric Hydraulic Tirfor Winch Technical Specification

| Model | Capacity |
|-------------|----------|
| TU8 | 800 kgs |
| TU16 | 1.6 T |
| TU32 | 3.2 T |

Wire ropes to suit TU8, TU16 & TU32

| Rope Length (M) | TU8 | TU16 | TU32 |
|-----------------|-----|------|------|
| 10 M | POA | POA | POA |
| 20 M | POA | POA | POA |
| 30 M | POA | POA | POA |
| 40 M | POA | POA | POA |
| 60 M | POA | POA | POA |
| 100 M | POA | POA | POA |

**Electric 440v, Hydraulic power packs to suit
TU16 or TU32 are available
Price on application**

Adjustable Mobile Gantries Technical Specification

| S.W.L | Height to U.S.B | Span (Metres) |
|------------|-----------------|---------------|
| 1 T | 1.8 – 3 M | 3 M |
| 1 T | 1.8 – 3 M | 4 M |
| 1 T | 2.5 – 4.5 M | 3 M |
| 2 T | 1.8 – 3 M | 3 M |
| 2 T | 1.8 – 3 M | 4 M |
| 2 T | 2.5 – 4.5 M | 3 M |
| 3 T | 1.8 – 3 M | 3 M |
| 3 T | 1.8 – 3 M | 4 M |

▪ **SHEAR LEGS/TRIPOD**

- Portable lifting tripod
- Tackles below ground lifting and lowering tasks

| S.W.L | Height (M) |
|---------------|------------|
| 500kgs | 2 M – 3 M |
| 1 T | 2 M – 3 M |



- Fixed, adjustable and modular lifting and spreader beams up to 15T capacity
- Allows big loads to be lifted safely from a single suspension point
- Concord supply for hire or sale

| Spreader Beams Technical Specification | |
|---|-----------------|
| S.W.L | Length (Metres) |
| 9.5 T | 1.5 M |
| 15 T | 2.5 M |
| 9.5 T | 3.6 M |
| 9.5 T | 4.2 M |
| 9.5 T | 9.6 M |

Other sizes available



- Installation & testing is available at additional cost
- Supplied in 3M lengths
- Hire rate includes hanging brackets/Gravloks, joining plates & endstops

| Lightweight Niko Track System Runway Beams Technical Specification | | | | | |
|--|---------------|---------------|----------|-------------------------|-------------------|
| Type | Niko 25 | Niko 26 | Niko 27 | 178 x 102 mm Beam | 254 x 102 mm Beam |
| S.W.L | Up to 500 kgs | Up to 800 kgs | Up to 1T | Up to 1.5T | Up to 3T |
| Track/Beam per 3M | POA | POA | POA | POA | POA |
| 4-Wheel Trolley to suit Niko Track | POA | POA | POA | Requires Girder Trolley | |



**Genie Machines
Technical Specification**



- Compact models
- Allows lifting and manoeuvres in congested work areas with ease
- The Air Hoist includes one gas bottle, any additional bottles are a one-off charge

| Model No | S.W.L | Height of Lift (Metres) |
|---|---------|-------------------------|
| GL 10 | 159 kgs | 3.05 M |
| GL 12 | 159 kgs | 3.66 M |
| SLA 10 | 454 kgs | 3.05 M |
| SLC 12 | 295 kgs | 3.66 M |
| SLA 15 | 363 kgs | 4.57 M |
| SLC 18 | 295 kgs | 5.48 M |
| SLA 20 | 363 kgs | 6.1 M |
| SLC 24 | 295 kgs | 7.32 M |
| SLA 25 | 295 kgs | 7.62 M |
| GH 3.8 Air Superhoist | 159 kgs | 3.8 M |
| GH 5.6 Air Superhoist | 136 kgs | 5.6 M |
| R250 | 682 kgs | 7.62 M |
| Counter balance unit (SLA only) or ext.tee | | |

Additional gas bottle POA

Genie Jib Booms

**Weekly Rate
POA**

Genie Load Platforms

**Weekly Rate
POA**

- Transforms your Superlift into a vertical crane or hoist.
- Positions tooling fixtures, hoists circuit breakers, engines etc.

- Fits easily over standard or adjustable forks – no tools required to install or remove. Assists in loading and unloading heavy objects





- The Scott-Jack plasterboard lifter is one or two person operation
- Lightweight system

Plasterboard Lifter Technical Specification

1.8 – 3.1 M Lift



- Immensely successful in the automotive trade
- Equally useful in other environments are our hydraulic floor cranes
- Counter balance units for external lifting point

Floor Crane Technical Specification

| S.W.L | TYPE |
|--------|---|
| 800kgs | Fold away |
| 1T | Fixed |
| 500kgs | Counter balance |
| 1T | Counter balance |
| 500kgs | Counter balance-demountable Additional weights (500kgs) (1 T) |

Adjustable Height Hoist Support System Technical Specification

- Comprising of a pivot arm
- An adjustable height Yoke and weight tray
- Provides a counter balanced external support point

S.W.L

Max 300 kgs

Max 500 kgs

Technical Specification

CABLE DRUM JACK

- Supplied as a pair.
- Each Jack has 3 Ton capacity complete with 2 metre bar

Capacity

3 T ON PAIR

6 T ON PAIR

HYDRAULIC JACK

- Wide variety of lifting applications

| H.O.L | 6T | 10T | 20T | 25T | 30T | 60T | 100T |
|-------|-----|-----|-----|-----|-----|-----|------|
| 152mm | POA | POA | POA | POA | POA | POA | POA |
| 305mm | N/A | POA | POA | POA | POA | N/A | N/A |

HEAD/TOE ROTATIONAL JACKS

- One of the most requested pieces of equipment are those for jacking operations
- Concord keeps a huge range to meet every eventuality.

S.W.L

H.O.L

5 T

25-230 + 368-573mm

10 T

25-233 + 413-646mm

RATCHET JACK

- Head and Toe lifting capability

SW.L

H.O.L

5 T

38-279 + 406-647mm

10 T

51-369 + 559-877mm

15 T

64-509 + 710-1155mm



HYDRAULIC RAMS

Also available

- Solid and Hollow
- Low height
- Double acting
- Locking collars
- Electric pumps

| Stroke/ Capacity | 50mm | 100mm | 150mm | 250mm |
|------------------------|-------|-------|-------|-------|
| Up to 5 T | P.O.A | P.O.A | P.O.A | P.O.A |
| Up to 10 T | P.O.A | P.O.A | P.O.A | P.O.A |
| Up to 20 T | P.O.A | P.O.A | P.O.A | P.O.A |
| Up to 30 T | P.O.A | P.O.A | N/A | N/A |
| Up to 50 T | P.O.A | P.O.A | P.O.A | P.O.A |
| Up to 100 T | P.O.A | P.O.A | P.O.A | P.O.A |
| More than 100 T | P.O.A | P.O.A | P.O.A | P.O.A |

HYDRAULIC PUMPS AND ACCESSORIES

- Detached hydraulic pump and ram sets
- 5 to 100 tonne capacity with a range of fittings and sizes to suit all tasks

| Pump to suit single Ram | Pump to suit multiple Rams | Gauges | 2-Way Manifold | 4-Way Manifold |
|-------------------------|----------------------------|--------|----------------|----------------|
| P.O.A | P.O.A | P.O.A | P.O.A | P.O.A |

Complete with 2 metre Hose



Manhole Lifter Technical Specification

- Lightweight
- Complete with keys
- Width/Length adjustable
- Easy assembly/dismantling

2 KEY

4 KEY





- Designed to carry electric or hand chain hoists on girders, RSJ's or beams
- Supplied in push travel or geared travel
- 500kg to 10T safe working load and from 60mm-305mm widths

Girder Trolley Technical Specification

| Capacity | Beam Size |
|----------|-------------|
| 1 T | 50 – 220mm |
| 2 T | 66 – 220mm |
| 3 T | 74 – 220mm |
| 5 T | 90 – 220mm |
| 10 T | 136 – 305mm |

Plate Clamps Technical Specification

- For lifting single sheets of metal vertically
- Requires minimum weight of 1/10 S.W.L

| Capacity | Beam Size |
|----------|-----------|
| 1 T | 0-20mm |
| 1.5 T | 0-20mm |
| 2 T | 0-25mm |
| 6 T | 0-50mm |



- Static attachment for joining lifting equipment e.g. chain hoist or electric hoist to a girder or beam
- Easy to install clamps

Adjustable Girder Clamp Technical Specification

| Capacity | Beam Size |
|---------------------------------|-------------|
| 1 T | 75 – 235mm |
| 2 T | 70 – 245mm |
| 3 T | 100 – 300mm |
| 3 T | 70 – 355mm |
| 5 T | 70 – 355mm |
| 5 T | 200 – 457mm |
| 10 T | 80 – 350mm |
| 3 T Side – loading clamp | 125 - 204mm |



For 110-VOLT Hoists

**Transformer/Leads
Technical Specification**

| | |
|--|--------------------------|
| 3.0 kVA | Twin 16amp |
| 5.0 kVA | Single 32amp. Twin 16amp |
| The 3kVA and 5kVA are complete with 20m x 4mm extension lead (16 or 32amp) | |



- Choose flat slings for maximum load stability

Chain Slings next page!

**Flat Belt Webbing Slings
Technical Specification**

| E.W.L | 1T Violet | 2T Green | 3T Yellow | 5T Red |
|------------|--------------|-------------|--------------|-----------|
| 1 M | POA | POA | POA | POA |
| 2 M | POA | POA | POA | POA |
| 3 M | POA | POA | POA | POA |
| 4 M | POA | POA | POA | POA |
| 5 M | POA | POA | POA | POA |
| 6 M | POA | POA | POA | POA |

Round Slings Polyester

- Gentle on the load
- Ideal choice for use in situations where chain slings could pose problems
- Use round slings for use on loads where extra grip is required

| E.W.L | 1T Violet | 2T Green | 3T Yellow | 5T Red |
|--------------|--------------|-------------|--------------|-----------|
| 0.5 M | POA | POA | POA | POA |
| 1 M | POA | POA | POA | POA |
| 1.5 M | POA | POA | POA | POA |
| 2 M | POA | POA | POA | POA |
| 2.5 M | POA | POA | POA | POA |
| 3 M | POA | POA | POA | POA |



Chain Slings Grade 80 Alloy Single Leg Technical Specification

| E.W.L | S.W.L 1.5T | S.W.L 3.15T | S.W.L 5.3T | S.W.L 8T |
|------------|---------------|----------------|---------------|-------------|
| 1 M | 7mm | 10mm | 13mm | 16mm |
| 2 M | 7mm | 10mm | 13mm | 16mm |
| 3 M | 7mm | 10mm | 13mm | 16mm |
| 4 M | 7mm | 10mm | 13mm | 16mm |
| 6 M | 7mm | 10mm | 13mm | 16mm |

- Supplied with safety hooks and shortening clutches



- Supplied with safety hooks and shortening clutches

Chain Slings Grade 80 Alloy Two Leg Technical Specification

| E.W.L | S.W.L 2.1T @ 0° - 45° | S.W.L 4.25T @ 0° - 45° | S.W.L 7.5T @ 0° - 45° | S.W.L 11.2T @ 0° - 45° |
|------------|-----------------------------|------------------------------|-----------------------------|------------------------------|
| 2 M | 7mm | 10mm | 13mm | 16mm |
| 3 M | 7mm | 10mm | 13mm | 16mm |
| 4 M | 7mm | 10mm | 13mm | 16mm |
| 6 M | 7mm | 10mm | 13mm | 16mm |

- Supplied with safety hooks and shortening clutches

Chain Slings Grade 80 Alloy Four Leg Technical Specification

| E.W.L (M) | S.W.L 3.1T @ 0° - 45° | S.W.L 6.7T @ 0° - 45° | S.W.L 11.2T @ 0° - 45° | S.W.L 17T @ 0° - 45° |
|--------------|-----------------------------|-----------------------------|------------------------------|----------------------------|
| 2 M | 7mm | 10mm | 13mm | 16mm |
| 3 M | 7mm | 10mm | 13mm | 16mm |
| 4 M | 7mm | 10mm | 13mm | 16mm |
| 6 M | 7mm | 10mm | 13mm | 16mm |

- Supplied with safety hooks and shortening clutches
- Can be used as 3 or 4 leg



- The three leg barrow sling is compatible with every hoist
- Particularly suited for use with both the Scaffold hoist and Gantry hoist

**Barrow Sling
Technical Specification**

S.W.L

250 kgs

**Skip Lifting Assembly
Technical Specification**

S.W.L

12 T

C/W Spacer bars

- For transporting skips around site using tower cranes

**Dee & Bow Shackles
Technical Specification**

S.W.L

Up to 5 T

5 T to 10 T

10 T to 17.5 T

Over 17.5 T

- Galvanised Green pin Bow Shackles
- Self colour large Dee Shackles
- Tested and certified in accordance with EN-13889
- (Grade 6)



- Lifting concrete ring sections
- In sets of two, three or four
- Up to 2T per pin

LEWIS PINS

- Used for lifting stone from above

Manhole Ring Lifting pin Technical Specification

25/32/35/38mm dia. Pin

120/150/170/200mm Wall thickness

S.W.L

500 kgs

25mm

1 T

28mm

Buckets/Muck Skips/Tipping Skips Technical Specification



Skip Type

Capacity

Mini 90 Litre

Mini 120 Litre

Round 250 Litre

Round 500 Litre

Round 1000 Litre

Boat 1000 Litre

Fork Lift Tipping Skip 500 Litre
1200 Litre

Frimeda/Deha Lifting clutches Technical Specification

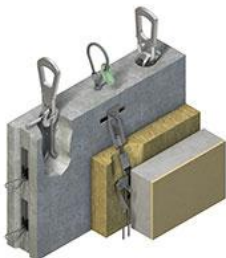

- For lifting pre-cast concrete segments with Frimeda/Deha fittings

S.W.L

Frimeda 0 - 2.5 T

Frimeda 3 - 5 T

Deha 2 - 2.5 T

Deha 4 - 5 T

Our extensive Hire range is also available for Sale.

In addition to our standard Hire range, we also supply various different makes and models to suit individual situations and requirements. Tailor made bespoke equipment can be designed and manufactured by Concord Lifting.

If you're after one-off site installations, permanent workshop solutions or just the reassurance that Concord's experience brings, then contact us. Not only will you receive exactly what you are after, we carry out examinations, testing and audits, giving peace of mind for safe and secure lifting solutions.



**Brick Lifts/Crane Forks, C/W safety net
Technical Specification**

Weekly Rate

POA

- 2 tonne safe working load multi-purpose crane fork is an industry standard
- Combining strength, durability and versatility
- Self leveling and telescopic units available



Fork Mounting Attachment

**Block Grabs - C/W safety net
Technical Specification**

S.W.L

1.8 T

1.8 T

- Model 1311 Series
- An ideal partner for the crane fork is our range of Block Grabs.

- 6 x standard Oxygen or 2 x 47kg propane
- 4 small
- 2 Small-2 Large

Bottle Carrier

S.W.L

500 kgs



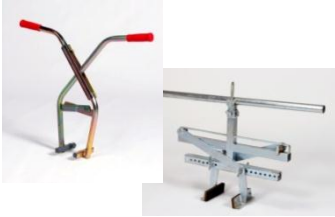

- Continuing our range of equipment to source safe and practical solutions to every lifting operation we stock a range of kerb and stone handling equipment.

Kerb and Block Handling Technical Specification

| | Width (mm) | Height (mm) | Length (mm) | Weight (kgs) |
|--------------------------|------------|-------------|-------------|--------------|
| Kerb stone handle | 0 -450 | 200 | 150 | 150 |
| Kerb Grab | 50 -540 | 130 | 200 | 250 |

Vacuum Block Grab

| Pad | S.W.L |
|-------------|---------|
| 300 x 300mm | 160 kgs |

- Ideal for paving slabs etc
- Battery powered. C/W 240v charger

Fork Truck Tine Brackets Technical Specification

| Capacities | Internal |
|----------------|----------------|
| 2/3/4 T | 150 x 70mm |
| 580mm External | 270mm Internal |

- Provides a central lifting eye for fork lift trucks

Fork truck Jib Booms

| Range | |
|----------|--------------|
| Capacity | |
| 2.5 T | 700 – 3700mm |
| 5 T | 700 – 3700mm |

- Convert a fork lift truck into a long reach crane





**Man-Riding Cages
Technical Specification**

| | H (mm) | W (mm) | D (mm) | Nett Weight | S.W.L |
|------------------|-----------|-----------|-----------|----------------|------------|
| 2 Persons | 2200 | 1270 | 780 | 225 kgs | 500 kgs |
| 4 Persons | 2200 | 1220 | 1220 | 440 kgs | 1 Tonne |

- Complete with 4 leg top chain assembly

Stretcher Cages

| | H (mm) | W (mm) | D (mm) | Nett Weight | S.W.L |
|------------------|-----------|-----------|---------------|----------------|---------|
| 2 Persons | 2000 | 775 | 259) 0 | 375 kgs | 300 kgs |

- Complete with 4 leg top chain assembly

Stretchers to suit above Cage

| |
|---------------------------|
| Weekly Rate POA |
|---------------------------|

**Pipe or Beam Bogie
Technical Specification**

| | |
|---------------------------|----------------------|
| Pipe Bogies 762kgs | Up to 250mm dia |
| Beam Bogies 762kgs | 340mm Internal width |

- Up to 2 tonne capacity cushion rubber or pneumatic tyres





- Concord supply for hire or sale, all models of pallet truck not just the standard 2500kg capacity 690mm by 1150mm.

Pallet Truck Technical Specification

| Model | Size |
|--------|----------------|
| Narrow | 520mm x 1100mm |
| Wide | 680mm x 1100mm |
| Long | 550mm x 2000mm |

All Terrain Pallet Truck

| Model | Size |
|-------------|-----------------------|
| All Terrain | 1250mm internal width |



- Designed for the purpose of moving brick or block packs around construction sites
- This rough terrain unit will just as easily move 1200kg pallets in warehouse or stores





- Up to 1000kg capacity rubber or pneumatic tyres

- Specialised units for handling drums, cylinders and barrels also available



**Flat Top/ Turntable Truck
Technical Specification**

| Capacity | L(mm) | W(mm) | H(mm) |
|---------------|-------|-------|-------|
| 500kgs | 1220 | 310 | 410 |
| 1T | 1525 | 760 | 485 |
| 1T | 2000 | 1000 | 485 |

**Sack Trucks
SAH 200**

| Capacity | Shoe Length | Width | Shoe Width |
|---------------|-------------|-------|------------|
| 255kgs | 305mm | 515mm | 365mm |



- Powered units available

**Stair
Climber Truck**

| Manual | Shoe Length | Width | Shoe Width |
|---------------|-------------|-------|------------|
| 100kgs | 470mm | 550mm | 310mm |
| 150kgs | 470mm | 550mm | 320mm |
| 300kgs | 227mm | 640mm | 480mm |



- The plasterboard trolley superbly complements the Scott-Jack lifter

**Plaster-board Trolley
Technical Specification**

| S.W.L | |
|----------------|----------------|
| 100 kgs | 2 Wheel |





- We have a skate for any load moving requirement.

**Piano Skate
Technical Specification**

| | Length (mm) | Width (mm) | Capacity |
|----------------|-------------|------------|----------|
| 2 Wheel | 630 | 460 | 200 kgs |
| 4 Wheel | 630 | 460 | 200 kgs |



- Ideal for heavy awkward objects
- The wheels can swivel 360° for easy manoeuvring
- Lifted by hydraulic jacks secured by ratchet straps

**Skoots
C/W 2 x Ratchet Straps
Technical Specification**

| Capacity |
|----------------|
| 1.8 T per pair |



- Any substantial piece of home or office furniture can be successfully moved with these highly popular trolleys

Furniture Moving Trolley

| Height | W | L | Capacity |
|--------|--------|--------|----------|
| 210mm | 385 mm | 385 mm | 1000 kgs |



- Rubber cover helps grip the load
- Easy to manoeuvre

Furniture Skate

| Height | W | L | Capacity |
|--------|-------|-------|----------|
| 150mm | 305mm | 610mm | 40 kgs |





- Essential tool when lifting and positioning heavy loads

Roller Crowbar Technical specification

Capacity

Pinch Bar 1.5 T

Roller Crow 5 T



Safety accessories on page 24!

Machine Skates Technical Specification



| Size | L(m m) | W(m m) | H(m m) | H*(m m) | Capacity |
|--------|--------|--------|--------|---------|----------|
| Size 1 | 210 | 102 | 59 | 94 | 20 T |
| Size 2 | 271 | 125 | 95 | 143 | 30 T |

H* Includes turntable / Equaliser

- Set of 4 including turntables, equalizers and handles

Nylon skates



- Roller skates in set of 3, 1 steerable, 2 fixed
- Helps put awkward loads on the move
- Nylon skates only to be used on clean floors

Capacity

Overall Height(mm)

| | |
|------------|-----|
| Up to 6 T | 115 |
| Up to 12 T | 102 |
| Up to 15 T | 102 |
| Up to 25 T | 110 |

- Complete with Shock Absorbing Lanyards
- Or fixed rope Lanyard



**Safety Harness
Technical Specification**

Weekly Rate
POA



- Retractable line which locks under sudden/rapid movement

**Fall Arrest Inertia Reel
Length of Cable (Metres)**

2.5 M

Up to 12 M

12 M +



- 10 or 20M length
- Provides fixing point for applications where there is a danger of falling

Temporary lifeline

Weekly Rate
POA

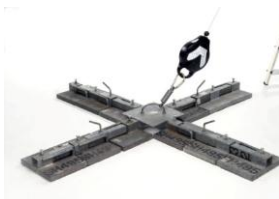

- Constructed from 1 Cruciform, 4 Extension arms & 12 Slottable weights
- Easy to set up
Ideal for short term maintenance
- Working on flat roofs

Roof man Anchor Systems

Weekly Rate
POA

Package deal! Hire Roof Man anchor, Fall arrest Block and Safety Harness for an amazing rate!

- Complete with Winch and Full Body harness
- Portable retrieval system offering maximum security to personnel working below ground

**Man-Riding Tripods
Technical Specification**

Weekly Rate
POA

- To suit above tripod

Bosun's Chair

Weekly Rate
POA

Hire and Buy Safely with Concord

Concord will help you meet your duty of care for employee and personal safety.

We ensure all Concord products conform to the Health and Safety at Work Act.

Whether you wish to pick up goods or have them delivered, Safety in the work place or at home is part of our everyday practice. Main Points to remember: Think Safely at Heights, Think Safely when Lifting and Moving, and take every precaution in the dress code to further reduce the risk of personal injury.





- Self Contained
- Battery operated
- Lifters for lifting and fitting glass units quickly and safely
- Most models have rotation and tilt features

Concord will also maintain repair and test customers own vacuum lifters. Comes with a 12 month warranty.

- Moving glass around isn't just a question of lifting, so we keep a range of glass stillage trolleys for hire or sale
- Concord will discuss, design and build trolleys, racks or stillages to suit individual requirements

Vacuam Handlers Technical Specification

| Model | S.W.L |
|---|---------|
| Woods 4 -Pad | 320 kgs |
| Twin Woods 4 - Pad | 640 kgs |
| MRT Cruciform Pattern | 320 kgs |
| MRT 6 Pad | 500 kgs |
| Glass boy one pad | 500kgs |
| 6 Pad + 2 extension pads Pannkoke 7011DS | 600 kgs |
| Bohle 4-Pad | 600 kgs |
| Hand Held 1/2/3 Pad | N/A |
| Al vac vacuum slab lifter | |

Stillage Trolley

| Length | Width | Height |
|--------|-------|--------|
| 1600mm | 800mm | 1700mm |

C/W 2
Lifting eyes



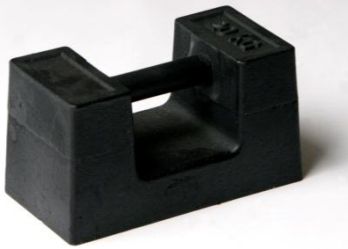

**Test Weights
Technical Specification**

Type

20kg Hand Weights

25kgs Hand Weights

500kgs Roller Weights

Weight tray 40 x 25kgs Weights



Load Cells/Load Indicators

Capacity

2.5 T

5 T

10 T

20 T

Testing Facilities

Our depots all have the necessary facilities to test, re-certify & repair all major makes/models of lifting equipment featured in our Hire/Sales product range.

We also undertake 'On-site' testing of fabricated lifting equipment, including:

- Gantries
- Lift Shaft/Motor Room beams
- Overhead Cranes
- Swing Jibs
- Runway beams/Running rails

In addition our Barking depot specializes in the repair/testing of Vacuum Handling Equipment, with its permanent facility for vertical or horizontal 'live load' calibration & testing.



1. Definitions

- a) The Contract is for the hire and the sale of goods ("Goods") detailed in the Contract, and the parties to the Contract are:
- b) The person, firm, company or other organisation hiring the Equipment and/or purchasing the Goods ("Hirer").
- c) Concord Lifting Equipment Ltd; Units 53 & 56 Wimbledon Stadium Business park, Riverside Road, London, SW17 0BE
- d) Any condition deemed invalid will not affect other conditions or the consumer's existing legal rights.

2. General

- a) **Extent of Contract and Cancellation**
The Contract is effective when Concord Lifting Equipment Ltd accepts the Hirer's order. Hires to individuals or partnerships shall not be for a period in excess of three months. In these circumstances, the Hirer must return the Equipment before the last day of the three month period.
- b) **Contract and Cancellation**
Concord Lifting Equipment Ltd reserves the right to charge for cancellation.
- c) **Termination**
Concord Lifting Equipment Ltd may terminate the Contract and repossess Equipment without affecting any rights to recover monies due, damages for breach of contract, where the Hirer is involved in insolvency or liquidation proceedings.
- d) **Ownership of Equipment and Goods**
At all times, equipment hired remains the property of Concord Lifting Equipment Ltd. Ownership of Equipment purchased transfers only when full payment is received by Concord Lifting Equipment Ltd. Specifications, technical descriptions are data serve as a guide only.

3. Hire

- a) **Basis of charging**
The hire charges are for the duration of the Contract and include weekends and Public Holidays.
- b) **Transport charges**
Delivery and collections including attempted calls are chargeable. If Equipment is not available or only partially available for collection then the Hirer will be charged for each journey on a mileage or time basis.
- c) **Deposits**
Deposits are set by Concord Lifting Equipment Ltd at amounts reasonably required and will be offset against any monies due. If a Deposit is required it must be paid by the Hirer before the hire period. Deposit balances are refunded upon return to Concord Lifting Equipment Ltd of Equipment in good condition. Balances of deposits by cheque will be refunded by cheque or BACS within 7 business days.
- d) **Cleaning and damage repair**
The Hirer will pay for required cleaning, re-sharpening, breakages and damage repair. The Hirer shall notify Concord Lifting Equipment Ltd immediately of all loss and damage to equipment.

e) **Loss of Equipment**

The Hirer undertakes to accept full responsibility for loss and damage to equipment from whatever cause. Concord Lifting Equipment Ltd will treat Equipment unavailable for collection from site, or un-returned after being off-hired by the hirer after reasonable notice as lost and the Hirer will pay a penalty charge for Equipment replacement and revenue loss. Hire charges accrue until full settlement is made.

4. Payment

a) **Payment Terms**

If the Hirer has a credit account then payment of any charges due under the Contract, including VAT, shall be made in full **by the end of the month following the date of the invoice**. If the Hirer does not have a credit account, then payment of any charges due under the Contract shall be made with the Hirer's order. Payment by the Hirer on time under the Contract is an essential condition of the Contract. Payment shall not be deemed to have been made until Concord Lifting Equipment Ltd has received cleared funds or cash. All business to be conducted on a Nett 30 day basis with a minimum hire period of 1 Week (7days). Over 1 week daily rate of 1/7th of weekly rate.

b) **Invoice Queries**

The Hirer should notify Lifting Concord Lifting Equipment Ltd of any queries concerning invoices in writing within 14 days of the invoice date. Concord Lifting Equipment Ltd Services will not grant an extension to credit account payment for unresolved invoice queries that have been notified after 14 days have elapsed from the invoice date.

c) **Overdue Accounts**

Should any portion of an account fall overdue then the total account will become due on demand. The Hirer will be liable for reasonable legal charges incurred by Concord Lifting Equipment Ltd in the recovery of Equipment and amounts due. In addition Concord Lifting Equipment Ltd may charge 5% per month interest in the event of the account not being paid within two calendar months of the last of the month shown as the date on our invoice and may suspend further services to the Hirer.

d) **Credit Limits**

Where Concord Lifting Equipment Ltd has granted a credit account to the Hirer, Concord Lifting Equipment Ltd may set a reasonable credit limit. Concord Lifting Equipment Ltd reserve the right to terminate or suspend the Contract if allowing it to continue would result in the Hirer exceeding his credit limit or the Hirer has already exceeded his credit limit.

5. Hirer's Responsibilities

a) **Inspection and receipt of Equipment and Goods**

The Hirer will sign to acknowledge receipt at delivery. Shortages must be agreed and noted on the delivery document. Equipment defects should be reported to Concord Lifting Equipment Ltd immediately.

b) **Delivery & collection of Equipment and Goods**

The Hirer will provide adequate delivery and collection access and be responsible for unloading and loading at delivery and collection. Equipment transported in the Hirer's own vehicle is at the Hirer's risk.

c) **Security of Equipment**

The Hirer accepts responsibility for Equipment security until its collection by or return to Concord Lifting Equipment Ltd and undertakes not to sell or relinquish possession, alter, repair or modify it in any way. The Hirer shall not sub-let or lend, sell, mortgage,

charge, pledge or part with possession of the equipment to any third party without written permission from Concord Lifting Equipment Ltd. The Hirer shall protect against distress, execution or seizure and shall indemnify Concord Lifting Equipment Ltd of all charges and expenses by failure to observe this condition.

d) **Safe use of Equipment and breakdown procedure**

The Hirer is responsible for the safe and correct operation of Equipment by competent persons not under the influence of alcohol or drugs and for its constant supervision within the range of children. The Hirer will immediately notify Concord Lifting Equipment Ltd of any Equipment breakdown or shortcoming without attempt at repair. The Hirer shall take steps to keep himself acquainted with the state and condition of equipment. If equipment is continued to be used in an unsafe state, the Hirer shall be solely responsible for all damage, loss or accidents. The Hirer will ensure any non-Concord Lifting Equipment Ltd, Equipment used in conjunction with or attached to Equipment also conforms to safety requirements. The Hirer will indemnify Concord Lifting Equipment Ltd in respect of all claims by any person for injury to persons or property caused by equipment whether arising under statute or common law.

e) **Return or collection of Equipment**

The Hirer may arrange for the return or collection of Equipment with any Concord Lifting Equipment Ltd outlet during normal business hours and when Equipment has been returned or collected Concord Lifting Equipment Ltd will issue a return note. The Hirer remains responsible for the Equipment, and in particular its security, until return or collection.

f) **Lost or stolen Equipment**

The Hirer agrees to insure Equipment on a full replacement basis against the risks of loss, theft and damage beyond economic repair and to pay to Concord Lifting Equipment Ltd any insurance claim proceeds. This liability is without prejudice to any Concord Lifting Equipment Ltd rights under the Contract.

6. Concord lifting Equipment' Responsibilities

a) **Hire rates**

Concord Lifting Equipment Ltd will maintain the agreed hire rates for the duration of the Contract.

b) **Safety and operating instructions**

Concord Lifting Equipment Ltd will provide appropriate written and/or practical instruction in the safe and correct operation of Equipment.

c) **Testing and inspection of Equipment**

Concord Lifting Equipment Ltd will test all electrical Equipment before commencement of hire. Equipment will be inspected and tested in accordance with relevant statutory requirements and if Equipment needs to be recovered from the Hirer for such purposes, substitute equipment of similar specification will be supplied.

d) **Delivery and collection**

Concord Lifting Equipment Ltd will endeavor to deliver or collect Equipment at the Hirer's request during the next business day, wherever possible.

e) **Returned Goods**

Concord Lifting Equipment Ltd will arrange an appropriate credit where the Hirer returns in unused condition Goods sold for use with Equipment.

f) **Limitation of liability**

The liability of Concord Lifting Equipment Ltd for claims made by the Hirer does not extend to any unforeseeable financial loss caused by late or non-delivery of Equipment and/or Goods, unsuitability, breakdown, stoppage or lawful repossession. Subject to the above Concord Lifting Equipment Ltd will be liable for negligence or error in the performance of its obligations under the Contract.

Concord Lifting Equipment Guidelines

Specialists in the Hire, Sales and Maintenance of Lifting Equipment

Your partner for safe and secure lifting solutions.

Concord Lifting Equipment.....

- Specialise in the Hire, Sales & Maintenance.
- Testing services to British & European standards, both at our depots & 'on-site'.
- Design bespoke lifting equipment systems for end users to legal requirements.
- Executive Hire News Depot of 2005 Award.
- Our equipment will be safe and suitable for its intended use.
- Outstanding lifting expertise.



Contact Details: Email: Sales@concordlifting.com

Opening Hours: 8-5 Monday-Friday Deliveries by prior agreement on Saturdays.

London South West

: Tel: 020 8946 7902

Head Office and Accounts

Units 53 & 56, Wimbledon Stadium Business Park, Riverside Road

London, SW17 0BE

Fax: 020 8946 7001

Email: wandsworth@concordlifting.com

London East

: Tel: 020 8594 7529

Unit 4, Buzzard Creek Industrial Estate, River Road, Barking, Essex, IG11 0EL

Fax: 020 8594 8674

Email: barking@concordlifting.com

London South East

Tel: 020 8465 5835

Units 15 & 16, Brocklebank Industrial Estate, Bugsby's Way

Charlton, London, SE7 7SX

Fax: 020 8465 5832

Email: charlton@concordlifting.com

Lifting Equipment & Services Ltd : Tel: 01480 217605

10 Foundry Way, Eaton Socon, St.Neots, Cambs, PE19 8TR

Fax: 01480 407108

Email: liftingequipment@btconnect.com

